

Volkswagen > New Beetle, New Beetle Convertible > 1998-2008

Body Exterior

63 - Description and Operation

.

Front Bumper Assembly Overview

Note:

- ◆ *Overview describes removal and installation of front bumper for vehicles through June of 2005. Removal and installation applies to vehicles from July 2005, except slight changes.*
- ◆ *Bumper cover is component part of front end and is removed together ⇒ [Front Part Assembly Overview](#) .*
- ◆ *It is necessary to observe tightening sequence of bolts - **10** - , - **12** - , - **15** - is observed to ensure surface alignment and joint.*

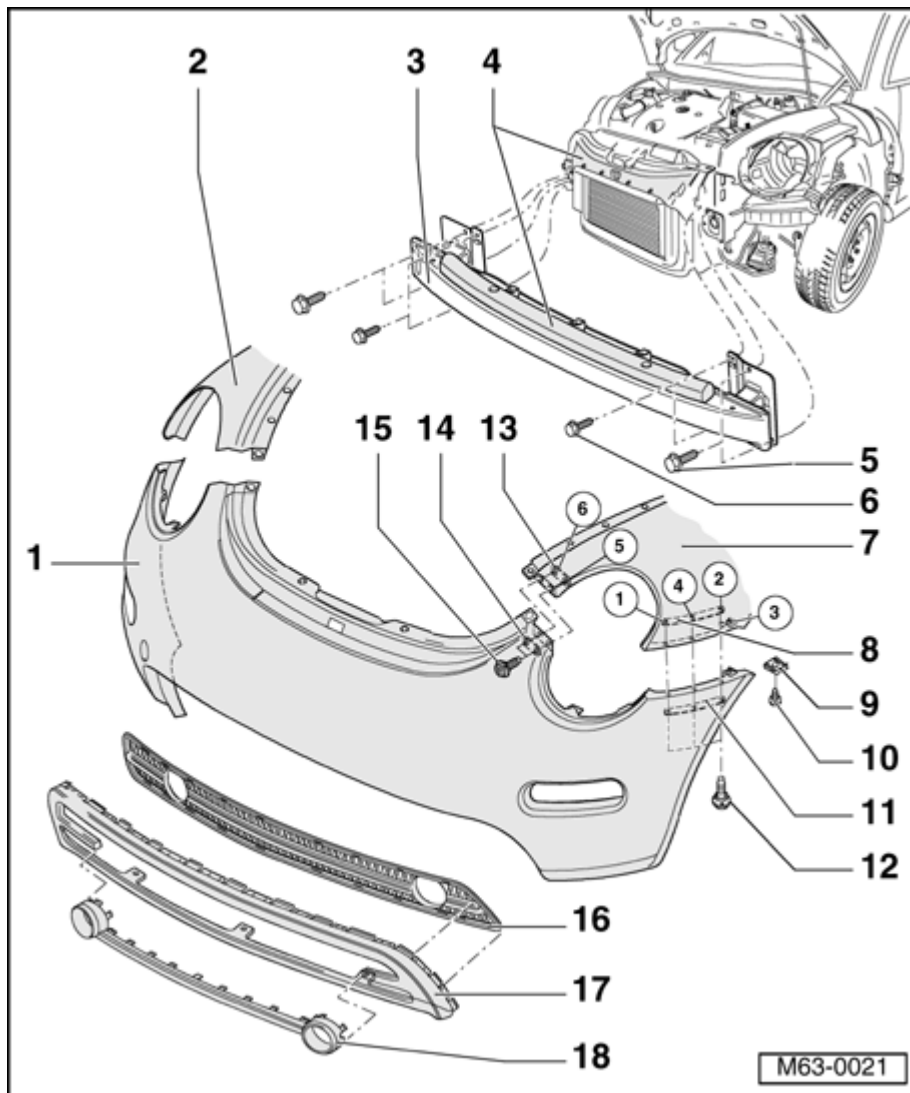

1 - Cover

◆ Removing:

- Remove headlight ⇒ Electrical Equipment - Repair Group 94
- Remove wheelhousing liners.
- Remove front part ⇒ [Front Part Assembly Overview](#) .
- If necessary, remove headlight washer system ⇒ Electrical Equipment - Repair Group 92
- Remove bolts and remove clips at left and right.
- Remove bolts and .

2 - Fender

3 - Bumper carrier

- ◆ Remove version with impact damper ⇒ [Lock Carrier Assembly Overview](#)

4 - Insulation

- ◆ Bonded using butyl adhesive sealing cord AKL 450 005 05

5 - Bolt

- ◆ 4x
- ◆ 30 Nm

6 - Bolt

- ◆ 4x
- ◆ 9 Nm

7 - Fender

8 - Base plate

- ◆ With welded captive nuts
- ◆ 2x

9 - Clip

10 - Bolt

- ◆ Insert with locking fluid D 185 400 A2
- ◆ Note tightening sequence

11 - Base plate

- ◆ With holes
- ◆ 2x

12 - Bolt

- ◆ Insert with locking fluid D 185 400 A2
- ◆ 6x

- ◆ 6 Nm

- ◆ Note tightening sequence

13 - Base plate

- ◆ With welded captive nuts

- ◆ 2x

14 - Base plate

- ◆ With welded captive nuts

- ◆ 2x

15 - Bolt

- ◆ Insert with locking fluid D 185 400 A2

- ◆ 4x

- ◆ 6 Nm

- ◆ Note tightening sequence

16 - Ventilation grid

- ◆ Clipped in cover

17 - Front spoiler

18 - Face plate

Copyright © 2008 Volkswagen of America, Inc. and Bentley Publishers. All rights reserved. Last processed: